

Scuola secondaria
di Primo Grado
di
San Giuseppe Jato

A.S. 2014-15
Progettazione grafica



Biblioteca scolastica

“Biblio-Video-Ludo-Teca”

Progettazione grafica realizzata dalle docenti
Donatella Taormina e Agostina Sarro





Lo stato attuale della biblioteca

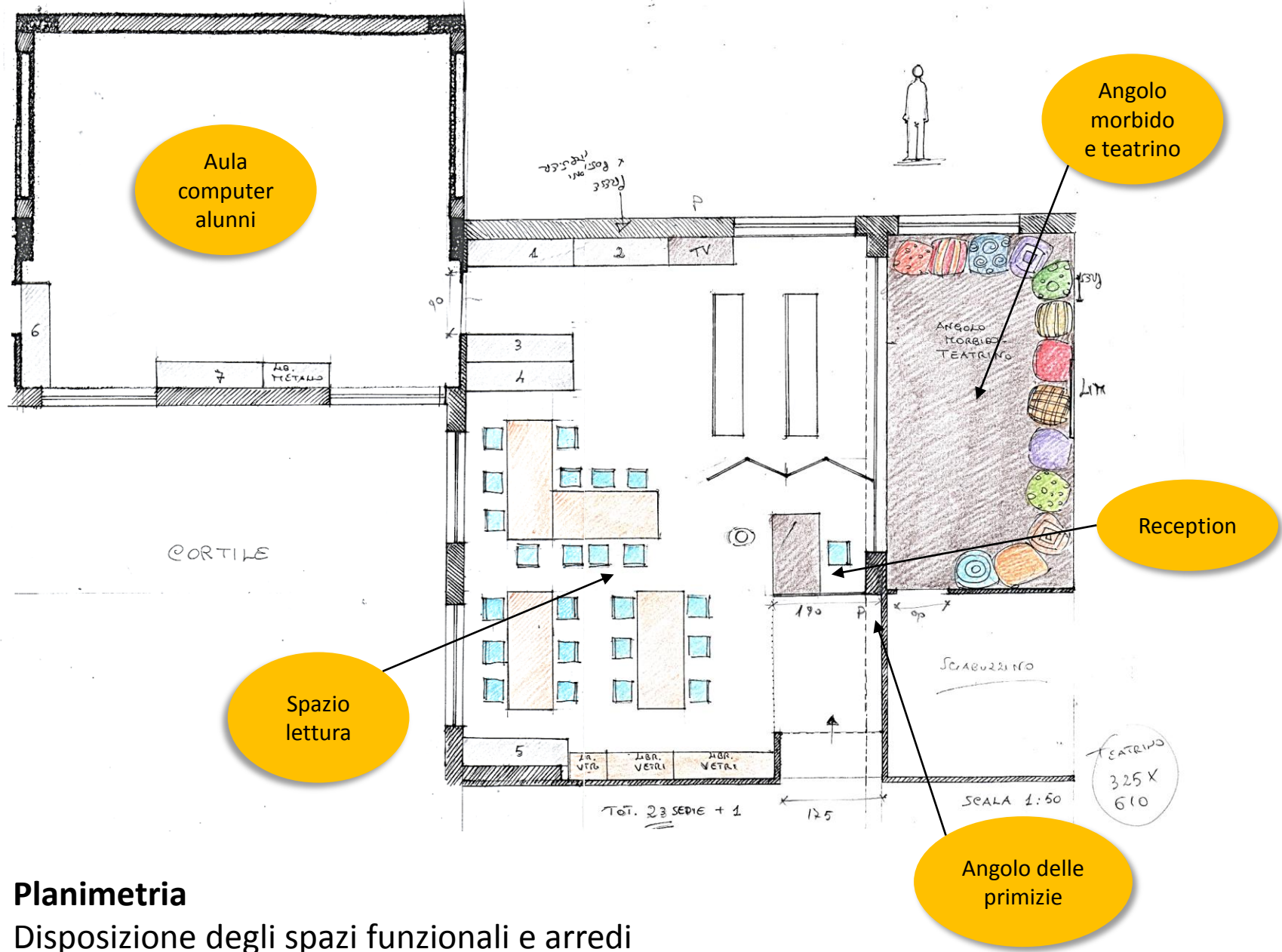

Planimetria

Disposizione degli spazi funzionali e arredi



Colloca frantello
Nanini
colorets.

Q97/L/120
colorets
frantello
Nanini
colorets.



Pannello decorativo con
lavori reali.

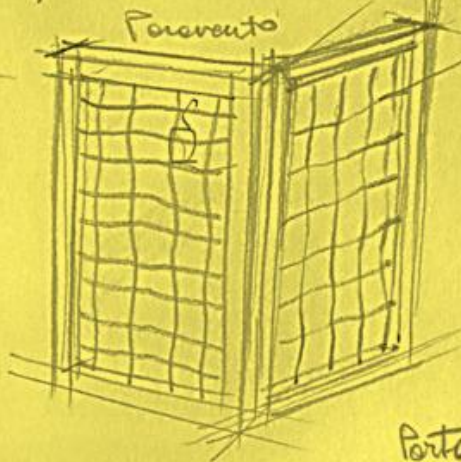

Foramento

Rete
Metallica

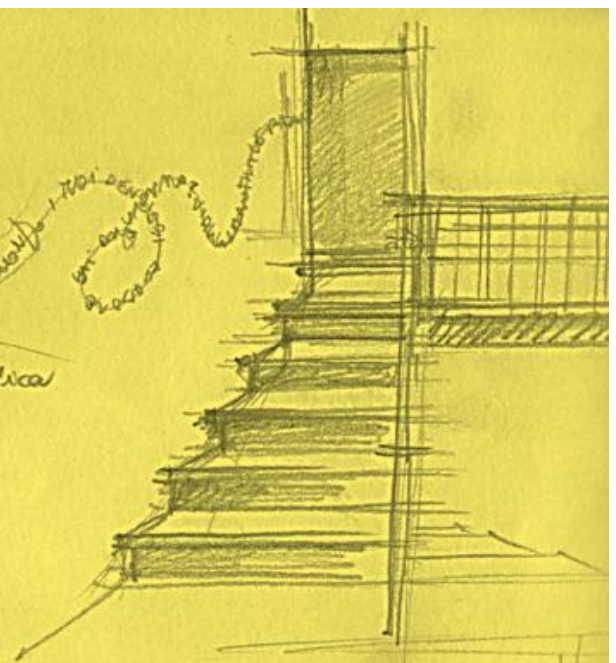

Porta con
concello.

legno
chiuso

Pitture

legno

legno

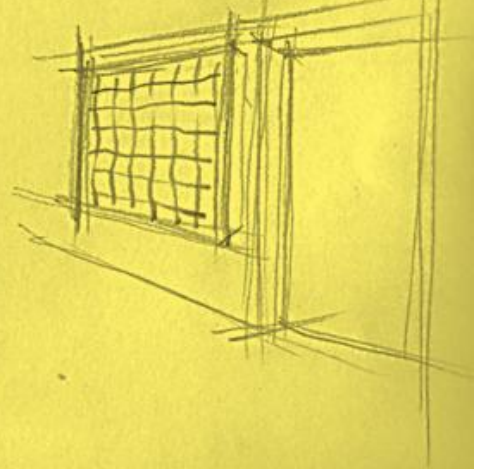

Bozzetti

Dall'ingresso principale all'ingresso della biblioteca

Il corpo scala

Ingresso principale

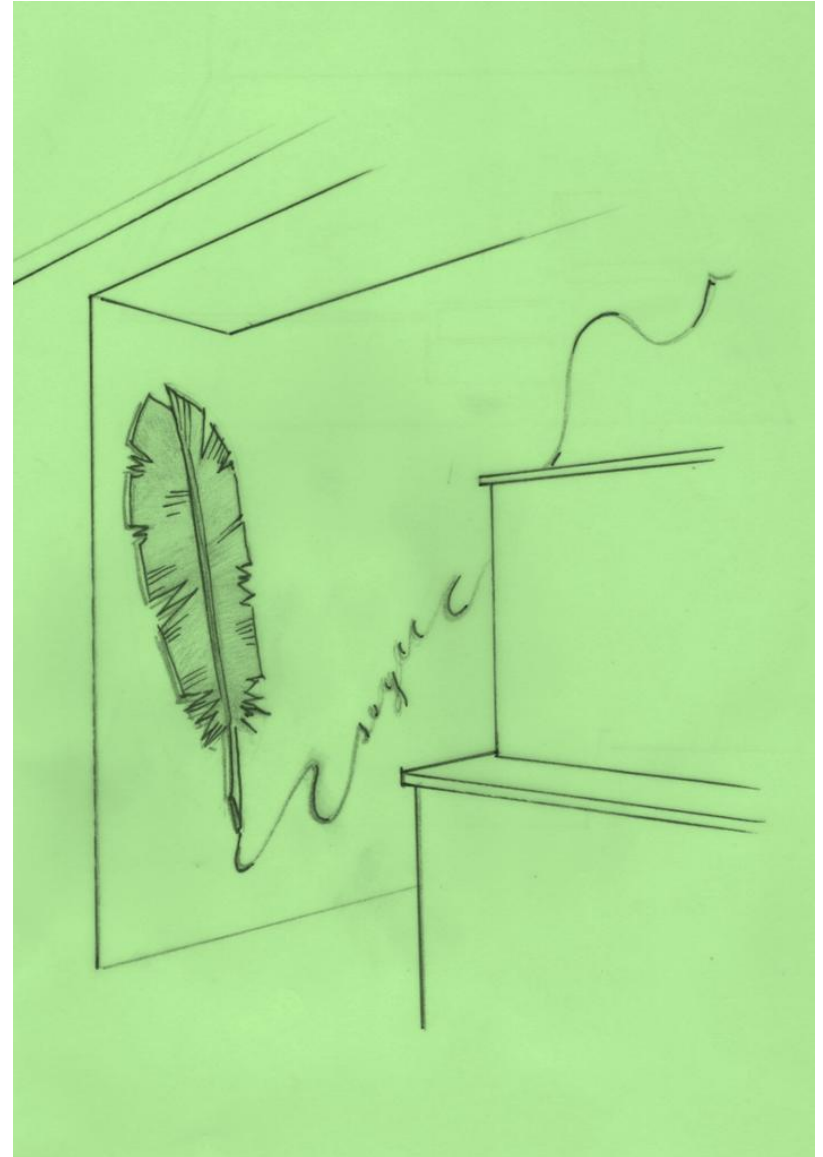
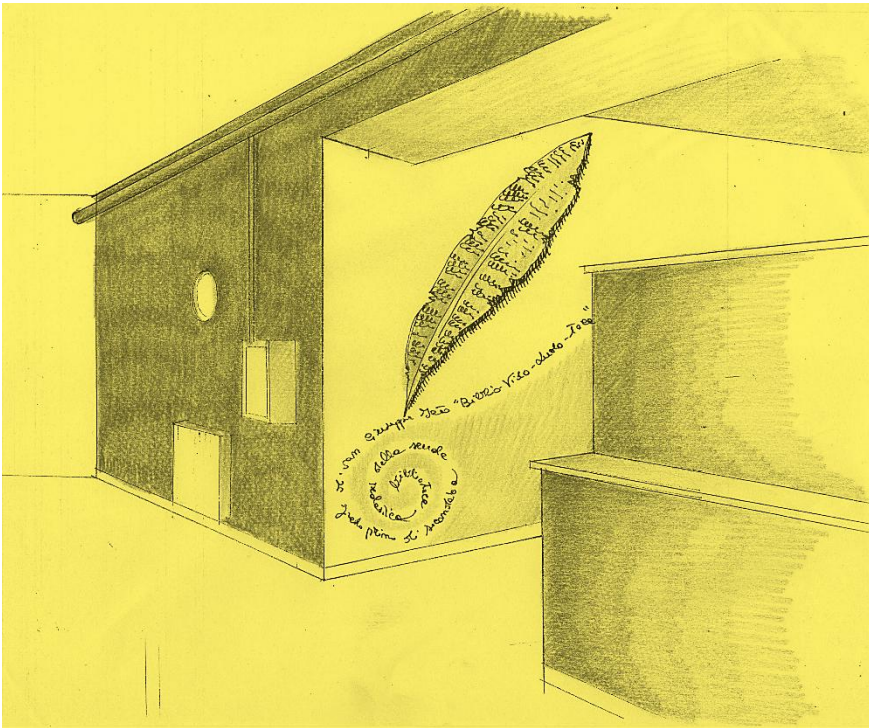

Secondo livello

CASA STUPEFACENTE DI CIOCCOLATO - UNA TAZZA DI LATTE E CEREALI CON ORZOTTO

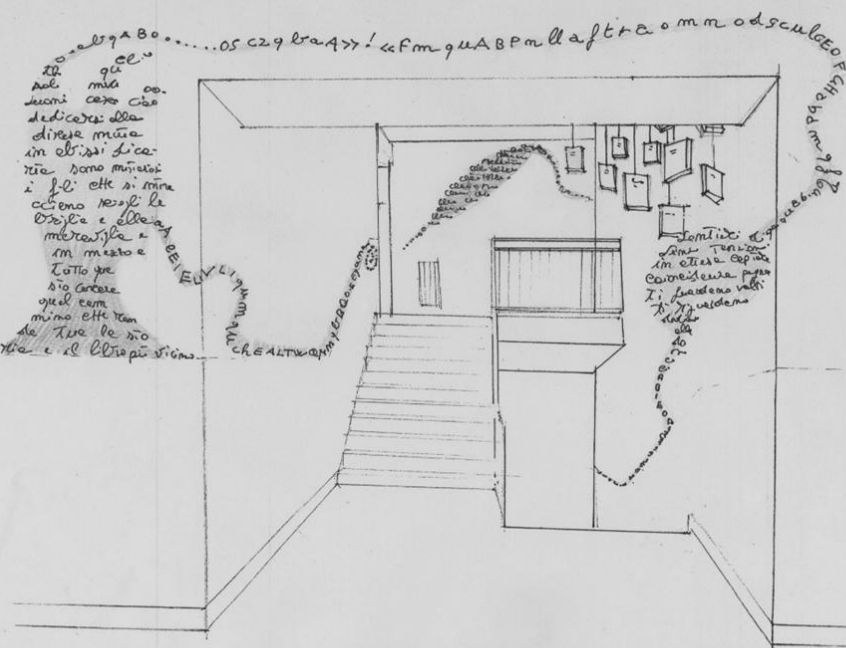
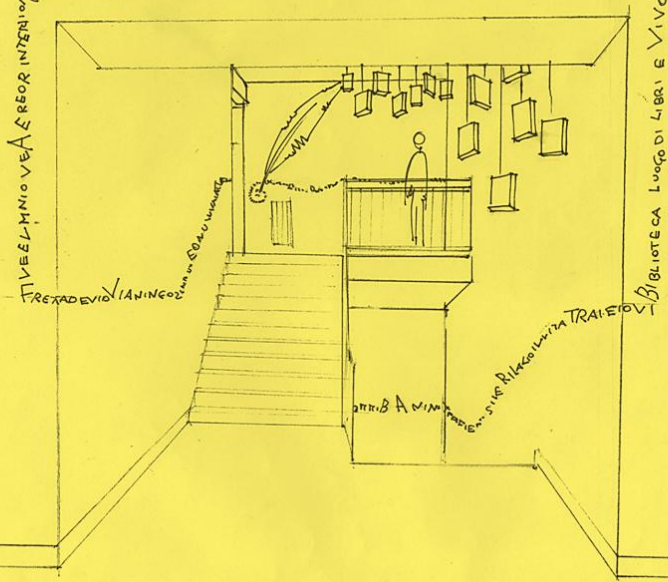

Cellinetti





Ingresso biblioteca (proposte n° 1 e 2)

Ingresso biblioteca (proposta n° 3, 4 e 5)

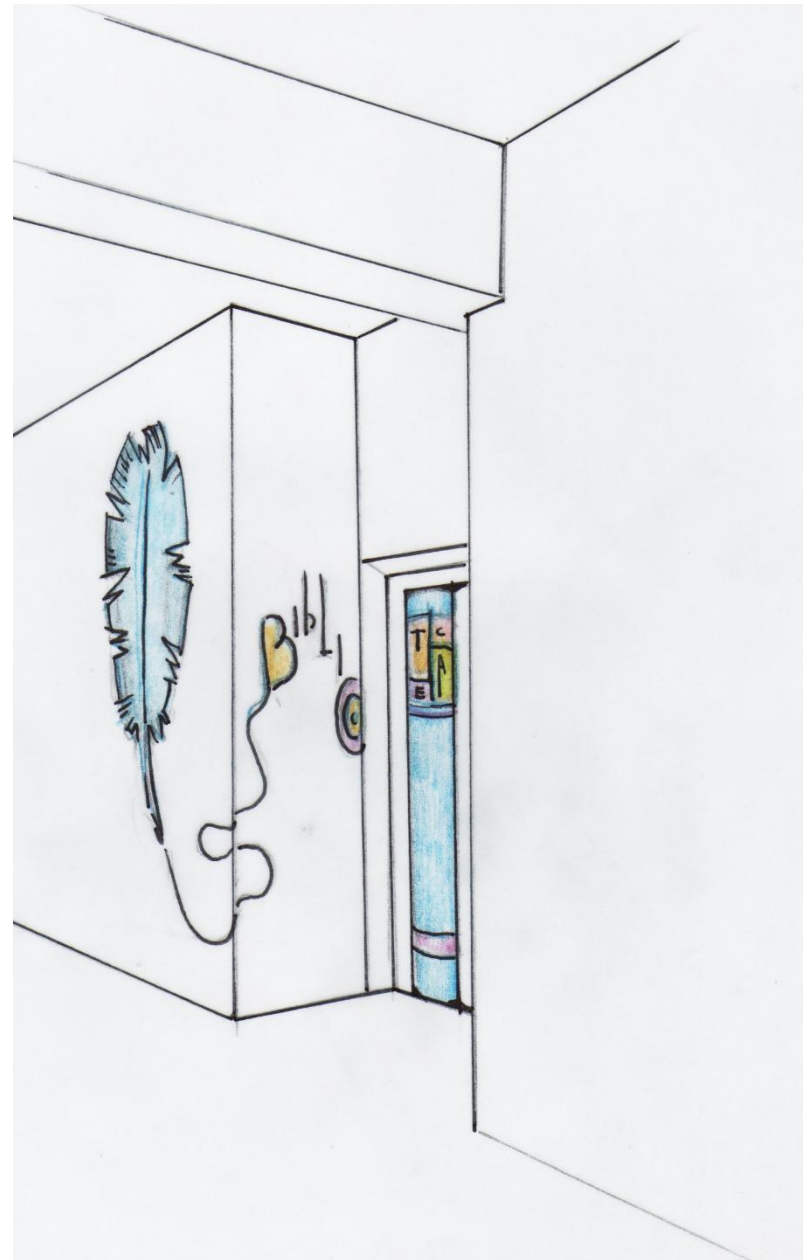
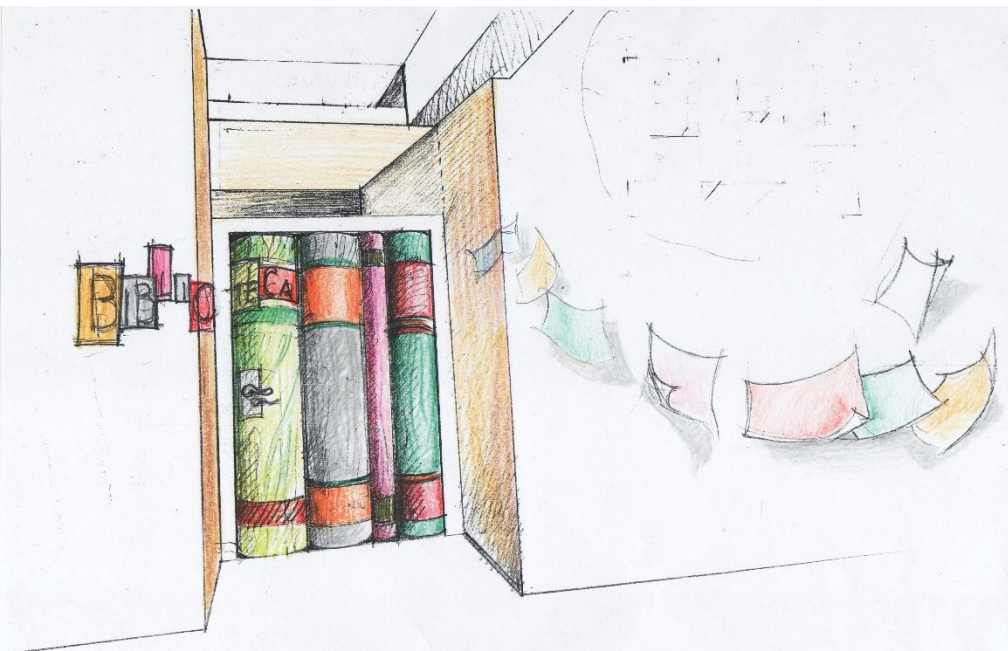
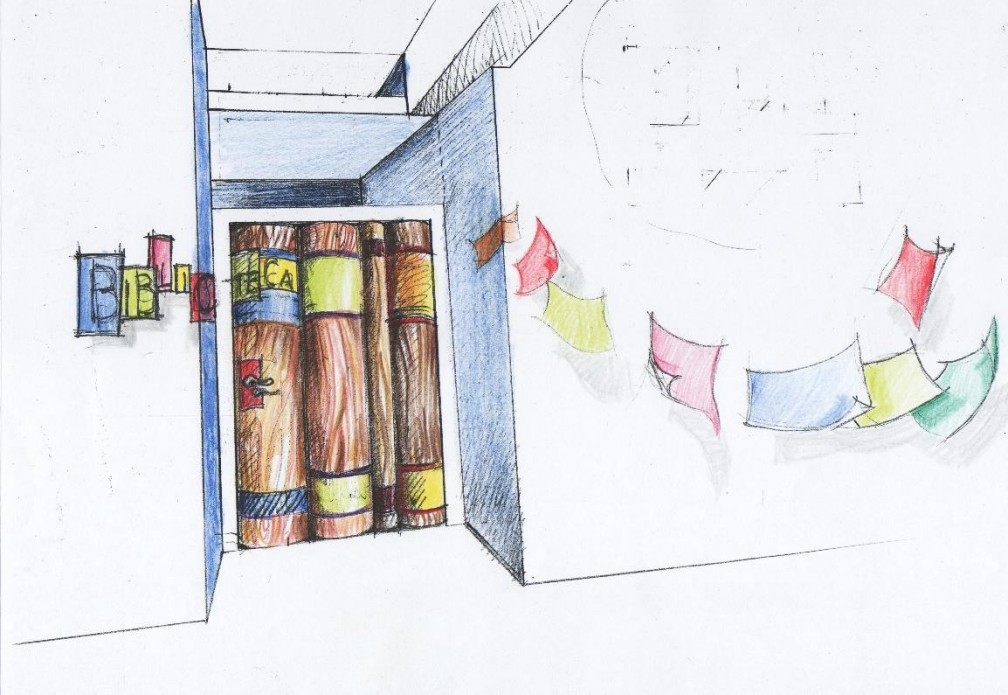

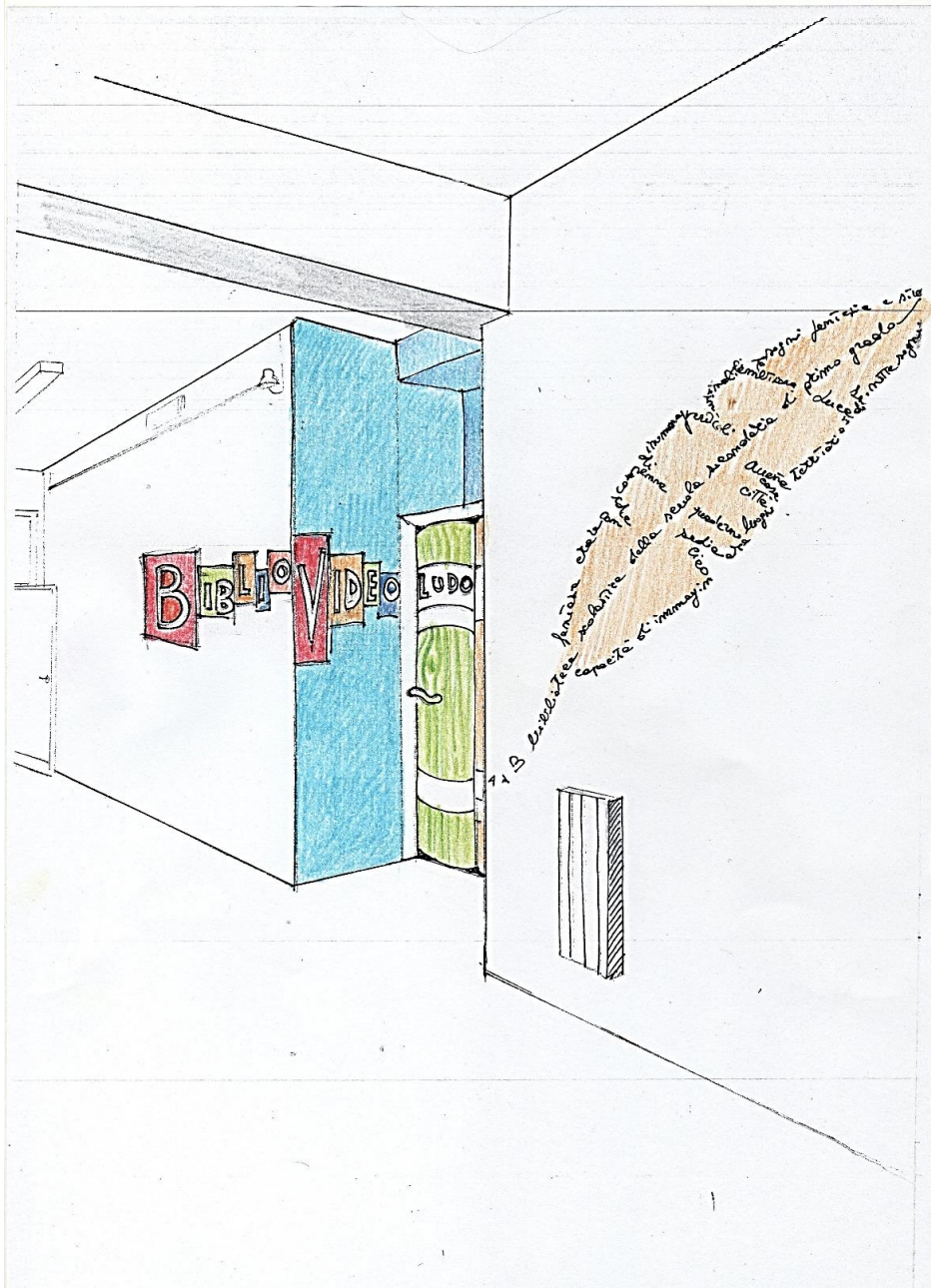
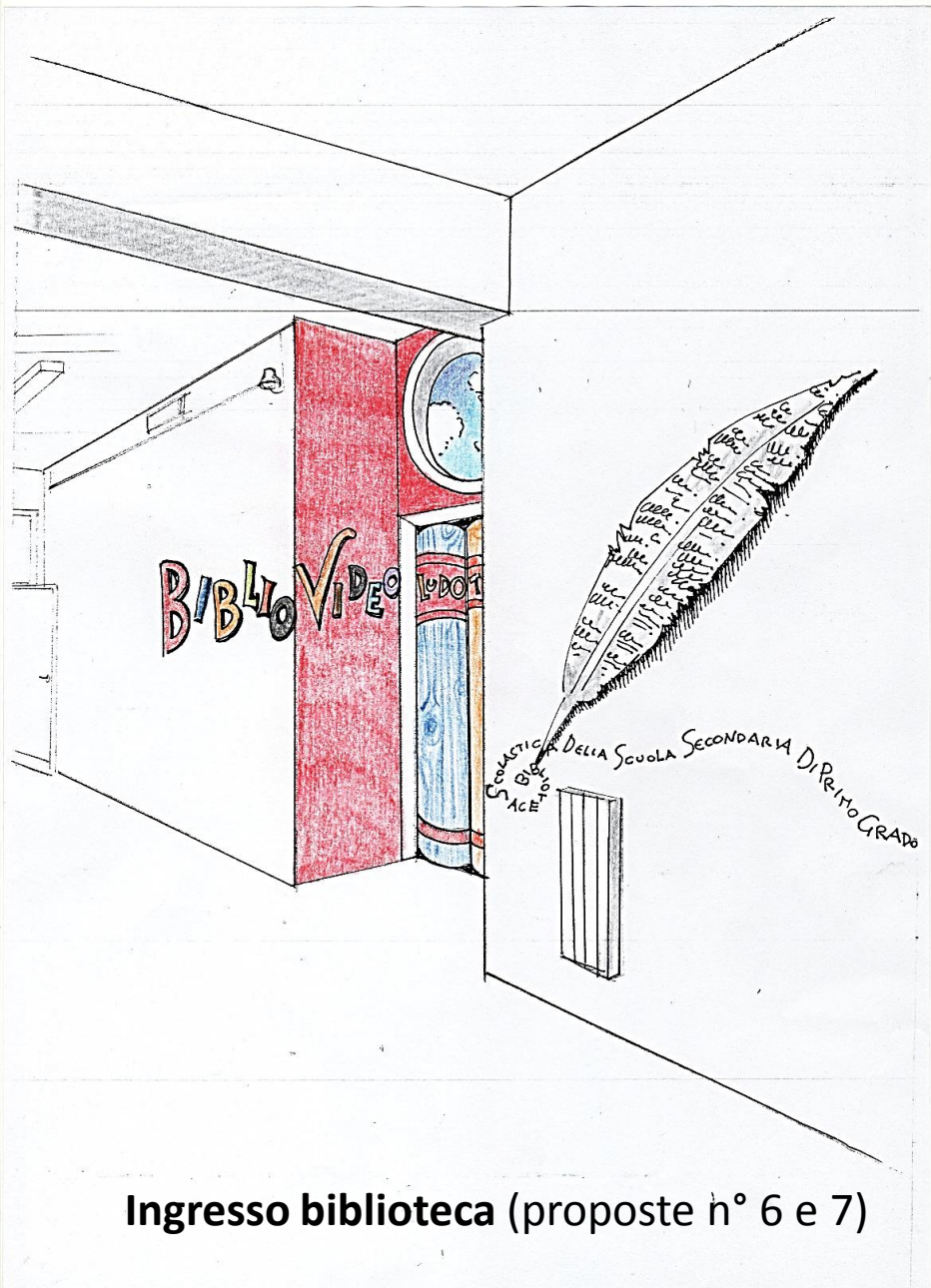

Ingresso biblioteca (proposte n° 6 e 7)

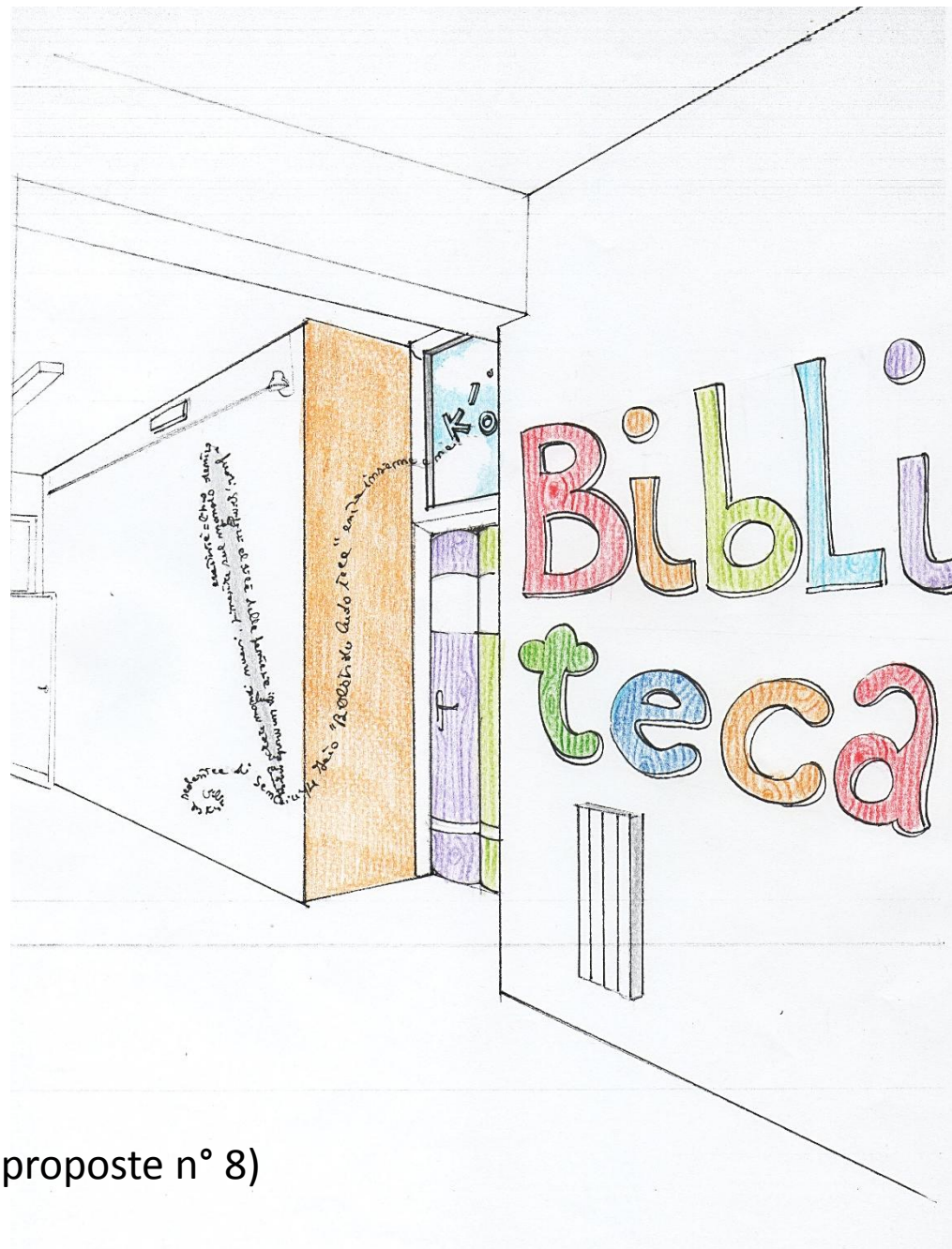

Ingresso biblioteca (proposte n° 8)

An architectural sketch of a library interior. The room features a grid ceiling with several rectangular light fixtures. On the left, there are two large windows. In the center, a rectangular table is surrounded by chairs. To the right, there are tall bookshelves and a desk with a chair. A window with curtains is visible on the far right wall. The drawing is done in black lines on a light background.

La biblio-video-ludo-teca

Interventi interni



Reception

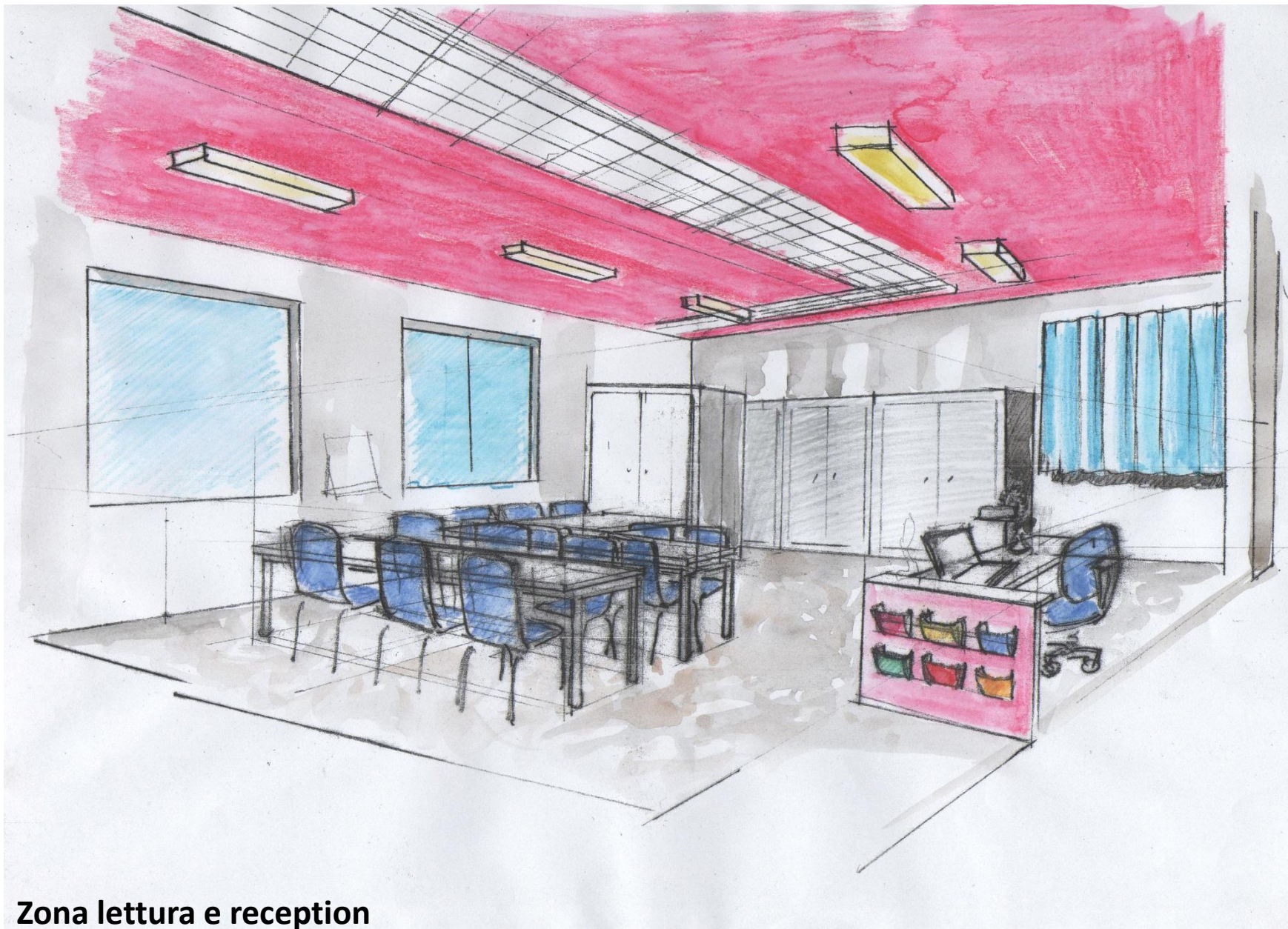

Zona lettura e reception



Zona lettura

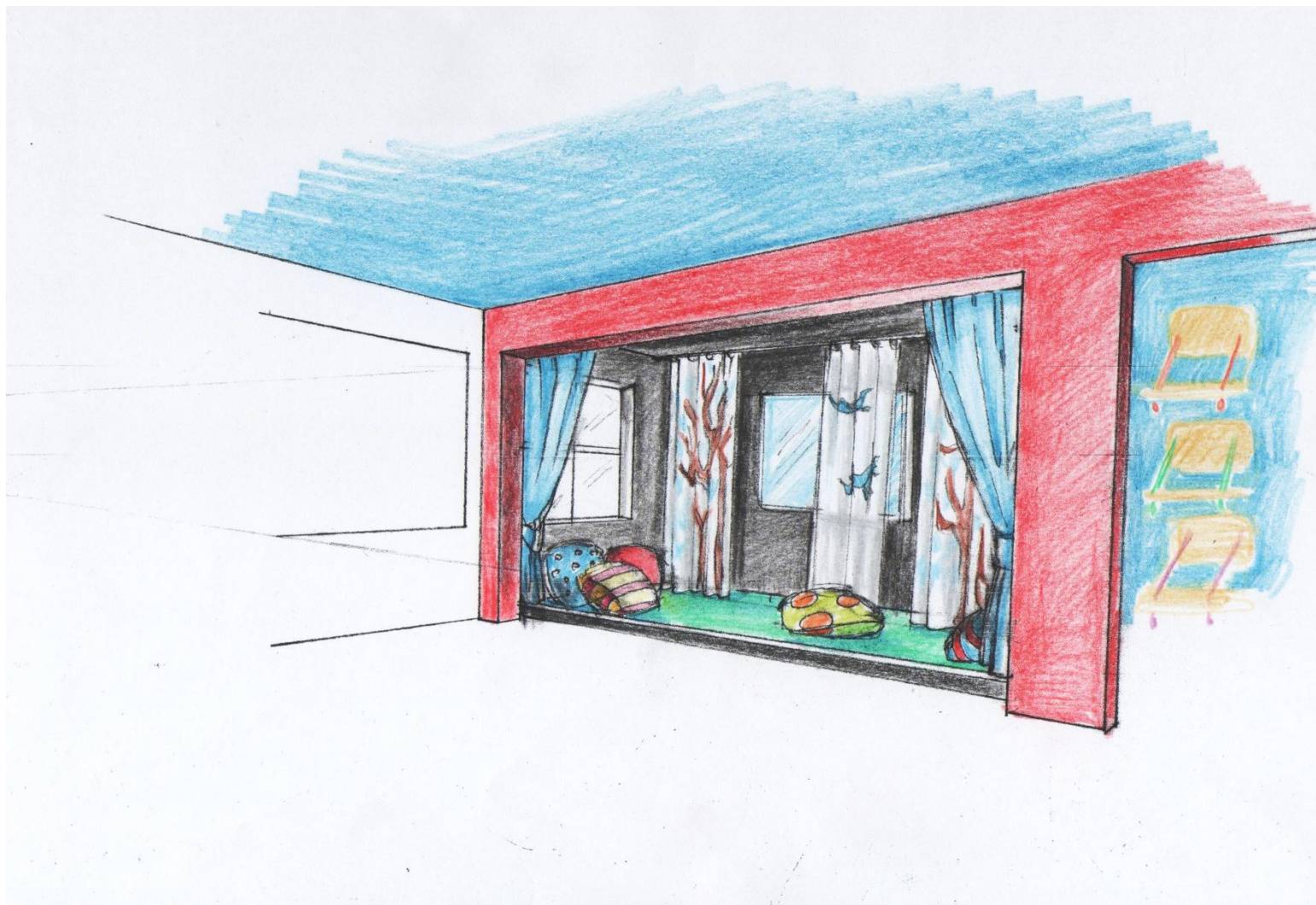

Angolo morbido-teatrino
(proposta n°1)



Angolo morbido-teatrino
(proposta n°2)



Angolo morbido-teatrino
(proposta n°3)



Angolo morbido-teatrino
(proposta n°3 bis)